

BUILDER Admiral
MODEL CNL 27M

FLAG



LENGTH 27 m

BEAM 6.5 m

DRAFT 2.4 m

BUILT 1977

REFIT 2017

GUESTS 10

CABINS 4

CRUISE SPEED 17 knots

MAX SPEED 20 knots

PRICE

€ 210,000



















 **FLACKTON YACHTING**
Superyacht Solutions





 **FLACKTON YACHTING**
Superyacht solutions















FLACKTON YACHTING
SOLUTIONS







 **FLACKTON YACHTING**
Superyacht solutions



 **FLACKTON YACHTING**



 **FLACKTON YACHTING**
Superyacht







 **FLACKTON YACHTING**
Superyacht solutions

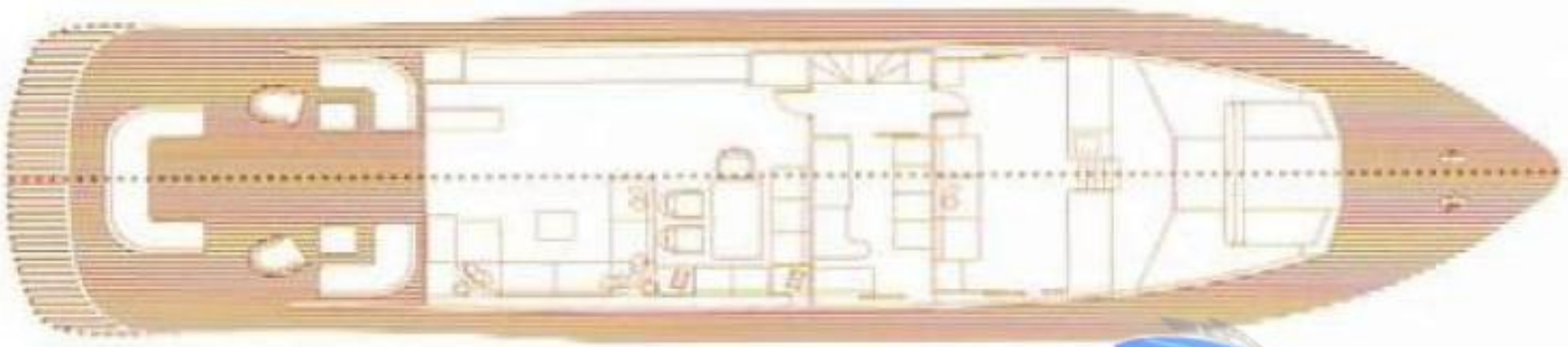
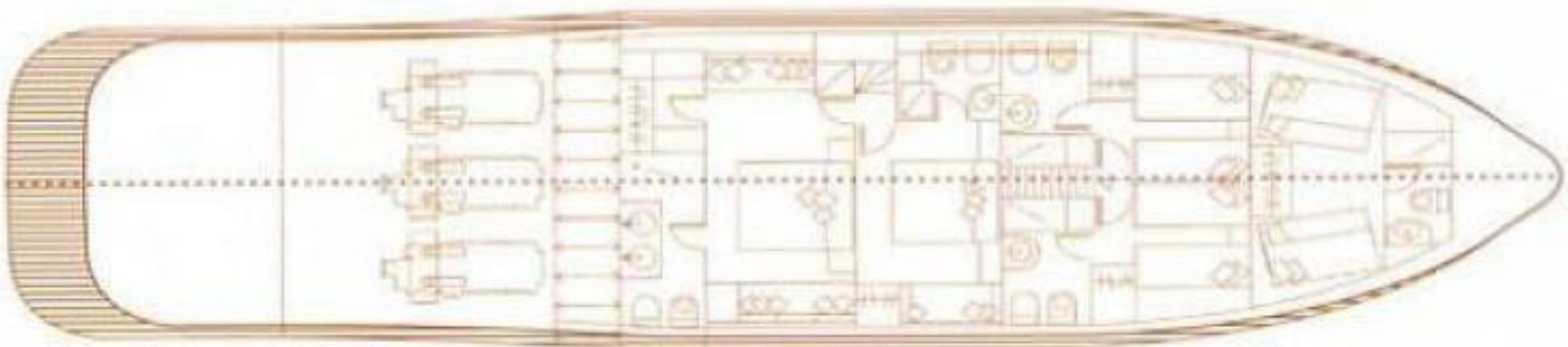
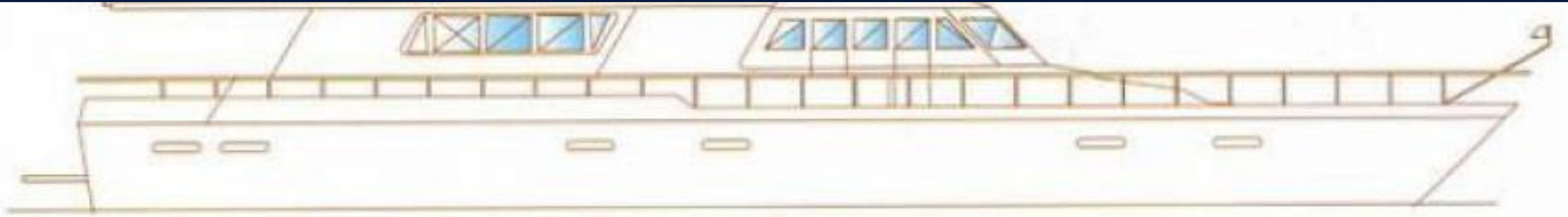

Table of Contents**1. SPECIFICATIONS****Admiral | CNL 27M****Disclaimer**

Yachts offered are subject to availability. The information provided is believed to be correct but not guaranteed and may not be used for contractual purposes. Specifications provided for information only.

1. SPECIFICATIONS

LOCATION - GREECE:

Construction - Wood Hull & Superstruction:

Builder - ADMIRAL CNL

Capacity:

Fuel Capacity - 10000ltrs

Water Capacity

Machinery:

Engine Hours - 8000/h

Engine Model - 3 X 870hp MTU

Gearbox

Generators - 2 X KOHLER 27KW

Propulsion - Propeller X 3

Fuel:

Diesel

Electricity:

Batteries

Shore Power

Air Conditioning:

Auxiliary Machinery:

Fire / bilge pump

Fresh water pump

Local water boiler

Water maker

Galley Equipment:

Fridge / freezer

Navigation equipment:

GPS

Plotter

VHF

TENDER & WATER TOYS - Yamaha engine plus jet ski: